

No. **100** ST

1-1/4 PITCH, NOMINAL 0.692"



Single - Split Taper Sprockets - With Hardened Teeth

Part No.	No. of Teeth	Diameters		Wgt. Lbs.	Part No.	No. of Teeth	Diameters		Wgt. Lbs.
		Outside	Pitch				Outside	Pitch	
100Q12H	12	5.420	4.830	3.50	100Q26H	26	11.050	10.370	17.90
100Q13H	13	5.820	5.223	4.30	100R26H	26	11.050	10.370	18.50
100Q14H	14	6.230	5.617	5.60	100Q27H	27	11.450	10.767	18.20
100Q15H	15	6.630	6.012	6.50	100R27H	27	11.450	10.767	19.60
100Q16H	16	7.030	6.407	7.40	100Q28H	28	11.840	11.164	19.90
100Q17H	17	7.440	6.803	8.20	100R28H	28	11.840	11.164	21.00
100Q18H	18	7.840	7.198	9.00	100Q30H	30	12.640	11.958	22.60
100Q19H	19	8.240	7.595	9.90	100R30H	30	12.640	11.958	24.50
100Q20H	20	8.640	7.991	10.80	100Q32	32	13.440	12.753	25.30
100Q21H	21	9.040	8.387	11.70	100R32	32	13.440	12.753	26.50
100R21H	21	9.040	8.387	13.30	100Q35	35	14.640	13.945	30.20
100Q22H	22	9.440	8.783	12.50	100R35	35	14.640	13.945	30.80
100R22H	22	9.440	8.783	13.80	100Q36	36	15.040	14.342	33.00
100Q23H	23	9.840	9.180	13.90	100R36	36	15.040	14.342	33.50
100R23H	23	9.840	9.180	15.00	100R40	40	16.630	15.932	42.00
100Q24H	24	10.250	9.577	15.50	100R45	45	18.630	17.920	50.00
100R24H	24	10.250	9.577	16.10	100R48	48	19.820	19.112	57.50
100Q25H	25	10.650	9.973	16.20	100R54	54	22.210	21.498	69.00
100R25H	25	10.650	9.973	17.00	100R60	60	24.550	23.884	84.00

* Sprockets with Q or R indicates Q1 & R1 bushings should be used, Q1 max. bore 2-11/16 & R1 max. bore 3-3/4.

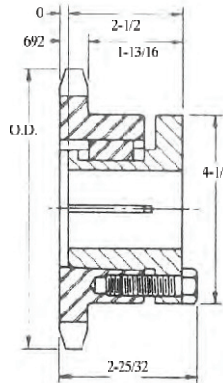

#100 Q1 Bushing

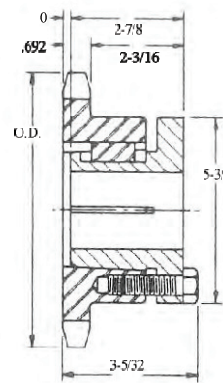

#100 R1 Bushing

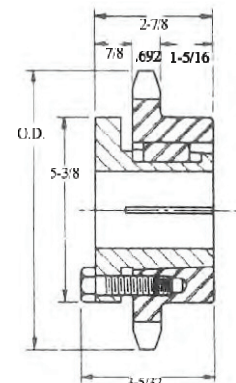

#100 R1 Bushing